

This is not a certified copy

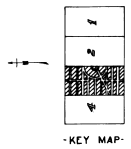

KEY MAP



PALM BEACH PARK

BEING A SUBDIVISION OF THE N ¼ OF SEC 26 T 43 S R 37 E
PALM BEACH COUNTY, FLA.

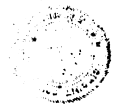

STATE OF FLORIDA
County of Palm Beach
30
April
1926
80
Chas. E. Dennis, one of said

80

BRIDGEMAN AND ALLEN, INC.
ENGINEERS
307 GARDENIA ST.
WEST PALM BEACH, FLA.

MARCH 1926

SCALE: 1 IN. = 100 FT.

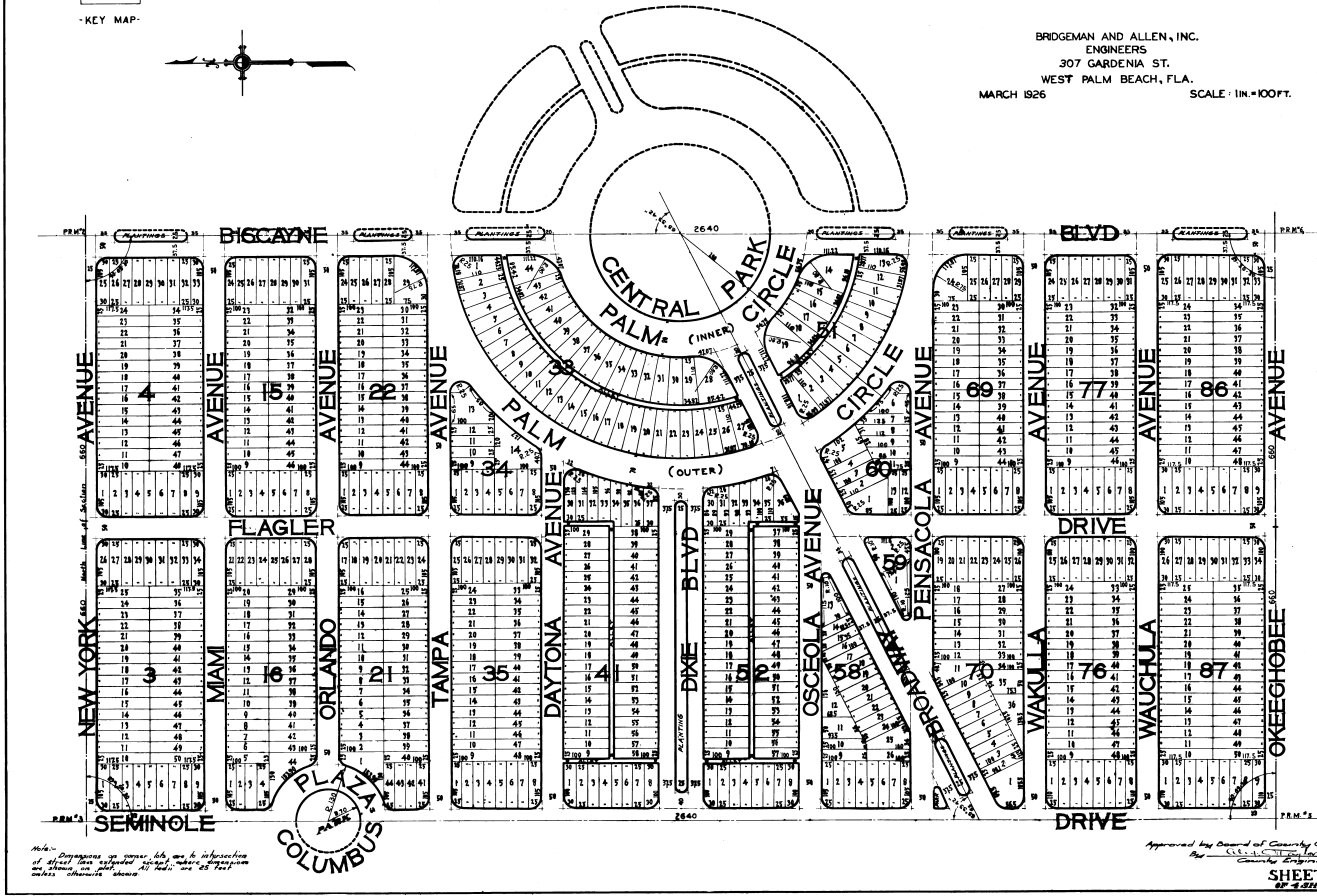

Note: Diagrams on pages 80, 81, and 82 in connection with this plat are intended to show the location of the lots and the location of the streets shown.

Approved by Board of County Commissioners
of Palm Beach County, Florida

SHEET 3
OF 4 SHEETS